

Typical elevation of a Vertical Slider.

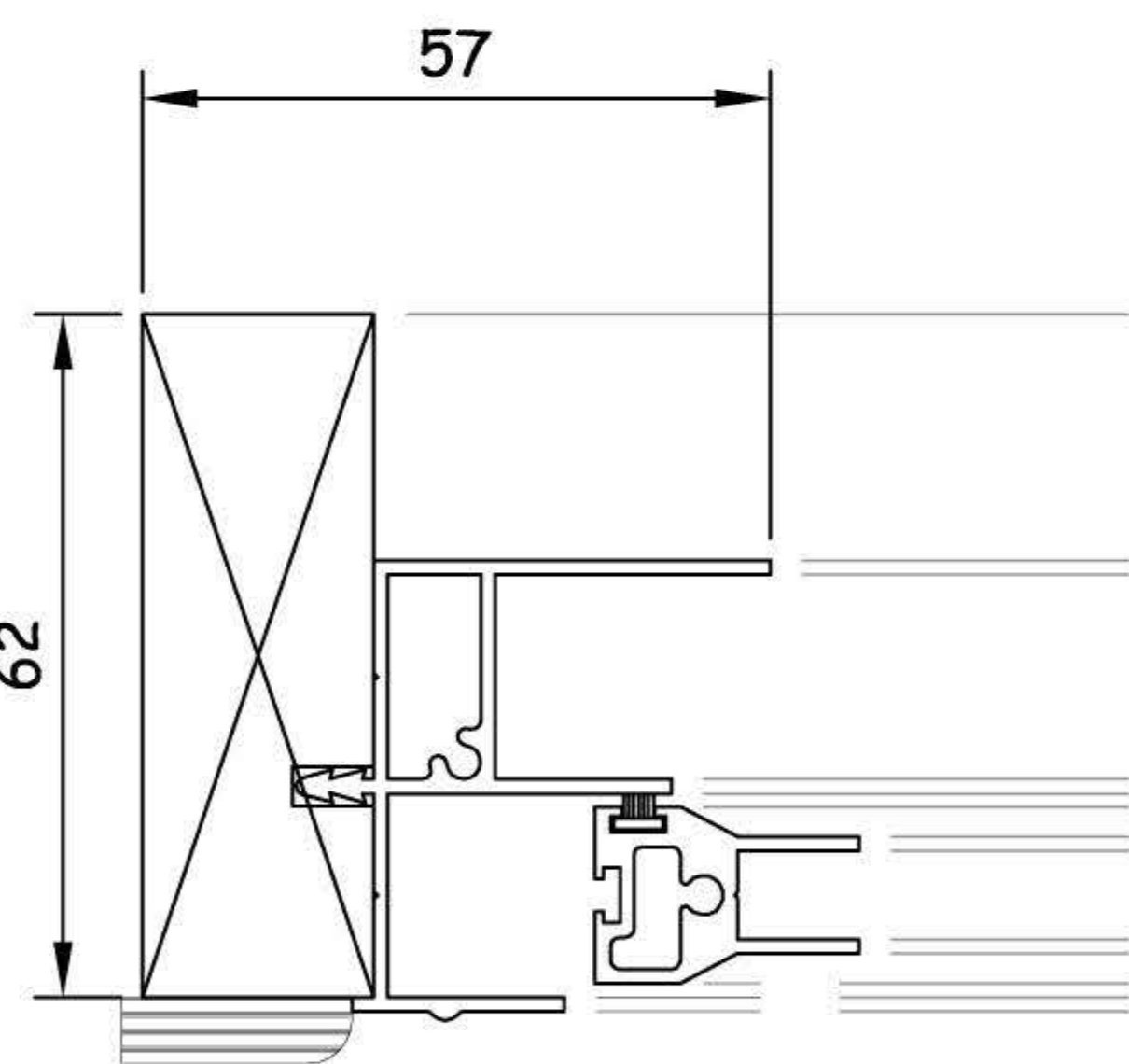
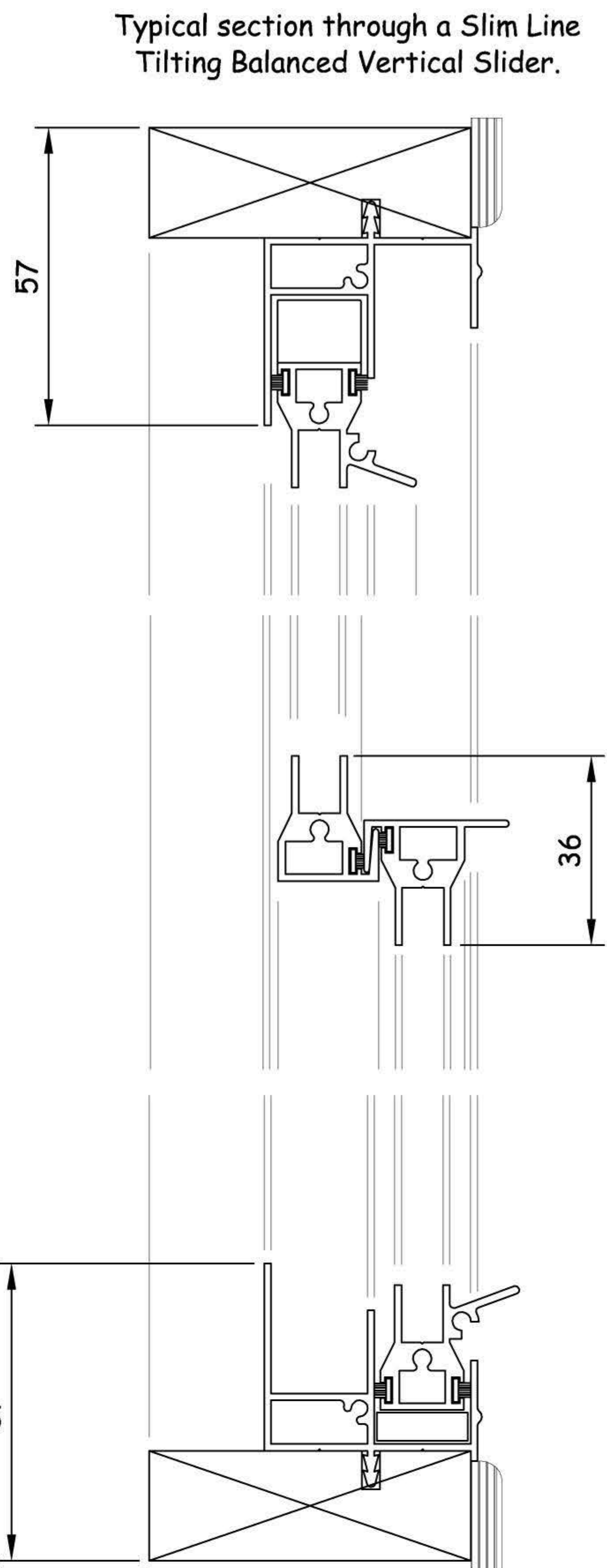

Typical jamb detail.

Specification:

Aluminium sections are to be extruded from 6060 alloy EN755-2.
 EP White Gloss - 60 Micron finish.
 All aluminium to be powder coated to BS 6496.
 Frames and sashes are to be mechanically jointed using BZP screws to DIN 7982 - 8 microns.
 The sub-frame is from English hardwood, kiln dried to KD:FAS1F.
 Sub-frames are butt jointed using BZP screws to DIN 965 - 8 microns. Standard sizes 45mm x 21mm & 62mm x 21mm.
 Non-standard sizes are available to order.
 All frames are factory glazed.
 A choice of 4mm or 6mm clear float annealed or toughened.
 6.4mm clear laminate or 6.4mm Acoustic Glass.
 Gaskets are in accordance with BS 2782 in a standard colour of BLACK.
 All sash polypropylene woolpiles are to BS 7386.
 Includes the new Brake Lock tilt action.
 Available with locking or non locking Fitch catch.
 All frames include upvc or timber trim

Revision:

Drg. No. BVS Tilt RF

Scale: 1:20 & 1:2 (at A4)

Client:

Drawn by:

Architect:

Date:

Contract:

**Tilting Balanced Vertical Slider details.
 Reveal Fix.**

Silent Night Secondary Glazing
Protech Direct
(www.secondaryglazing.com)
 Blue Bridge Centre
 Horndale Avenue
 Newton Aycliffe
 Durham
 DL5 6DS
 tel: 01325 310520